

**SCA**

TM

**2000KG  
MAXIMUM VEHICLE LOAD  
ELECTRIC MOTORISED  
JOCKEY WHEEL**

**PRODUCT MANUAL**



PLU 632324

**WARNING**

Always pay attention to the **Electric Motorised Jockey Wheel**. If the **Electric Motorised Jockey Wheel** abnormally warps / twists / bends, stop working immediately.

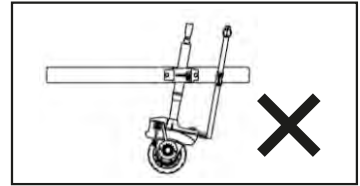
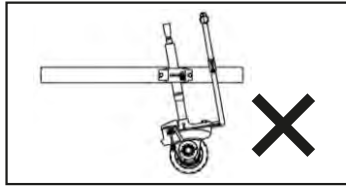
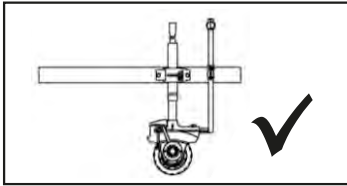

Apply blocks to the wheels of the trailer, camper, boat or caravan when on an incline.

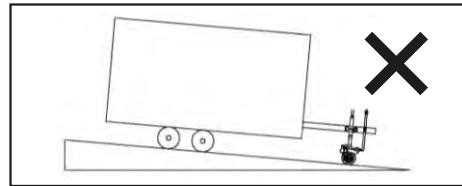
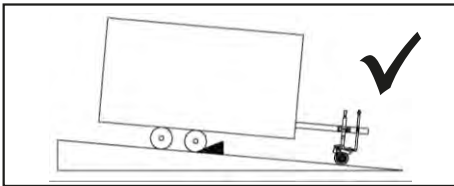

The height of the **Electric Motorised Jockey Wheel** is able to be manually adjusted for easy hitching to the tow vehicle, Only move with the jockey wheel in lowered position.

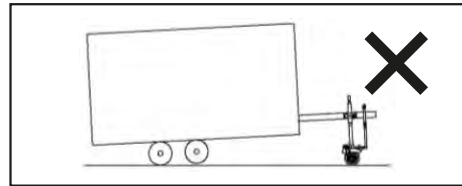
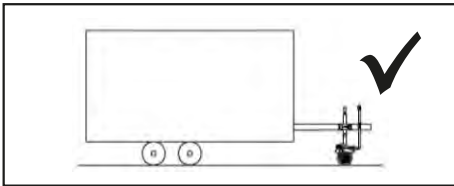

**DO NOT** push or pull your trailer, camper, boat or caravan on over 5° gradient.

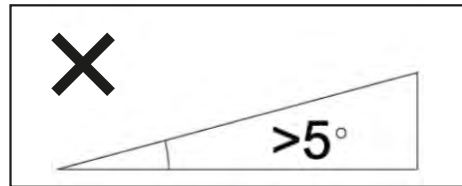
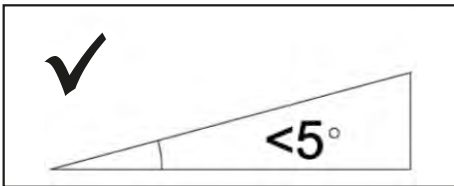

When you push or pull vehicle on gradient, make sure the **Electric Motorised Jockey Wheel** is in the lowered position.

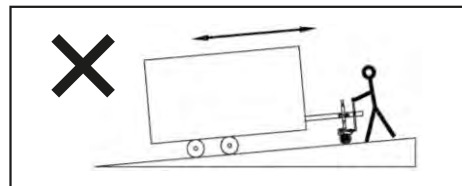
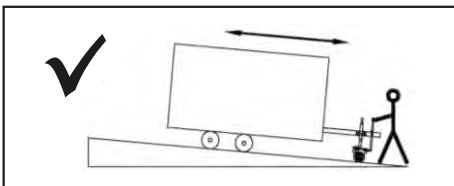

## SAFETY PRECAUTIONS

1. Please read this manual carefully before use. Keep manual in a safe place for future reference.
2. Please observe the surrounding area when operating the **Electric Motorised Jockey Wheel**.
3. Please disassemble the **Electric Motorised Jockey Wheel** when not in use.
4. **DO NOT** exceed the rated capacities when using the **Electric Motorised Jockey Wheel**.
5. **DO NOT** use the **Electric Motorised Jockey Wheel** for long distance movement as motor will overheat.
6. **DO NOT** submerge **Electric Motorised Jockey Wheel** in water.
7. Always disconnect the **Electric Motorised Jockey Wheel** power cable when not in use.
8. Stop operating the **Electric Motorised Jockey Wheel** if the unit **CANNOT** find traction on slippery surface.

## PARTS DIAGRAM

The below image shows the parts that are included in the **Electric Motorised Jockey Wheel**

- |                        |                             |
|------------------------|-----------------------------|
| 1. Motor & Gear System | 4. Jockey Wheel Lift Handle |
| 2. Control Box         | 5. Handlebar                |
| 3. Mounting Bracket    | 6. Control Handle           |

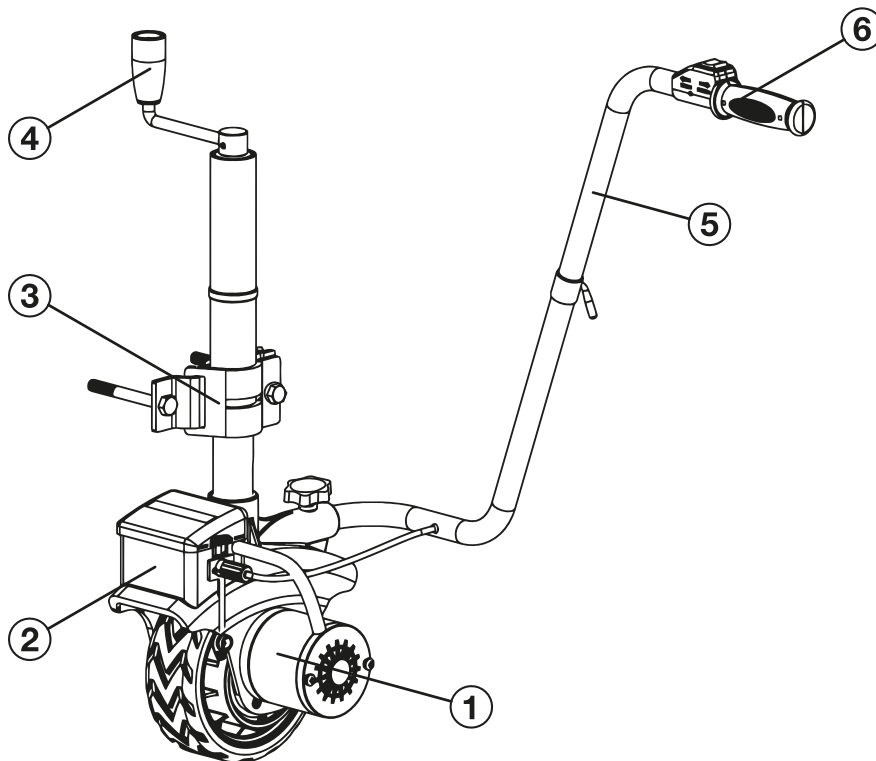

## INSTALLATION OF THE ELECTRIC MOTORISED JOCKEY WHEEL

**Step 1:** Connect the **Upper Handlebar** and the **Lower Handlebar** using the **M8 Lock Bolt**.

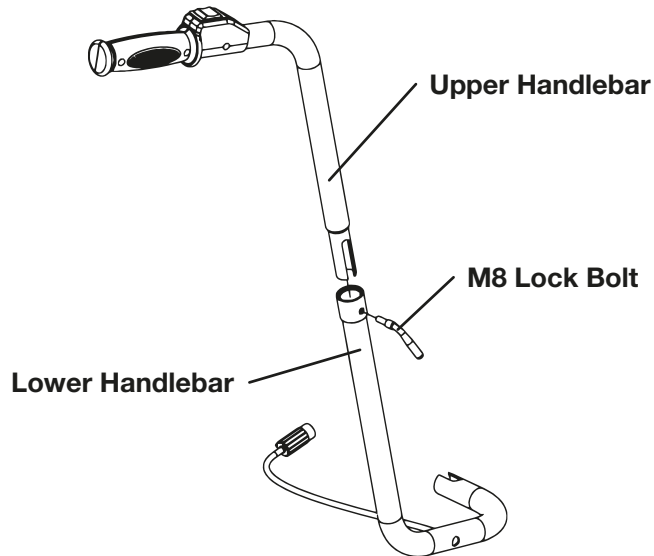

**Step 2:** Attach the **Assembled Handlebar** to the **main body** using the **M8 Lock Knob**.  
Connect the **Plug** of the **Handle Cable** into the **Control Box**.

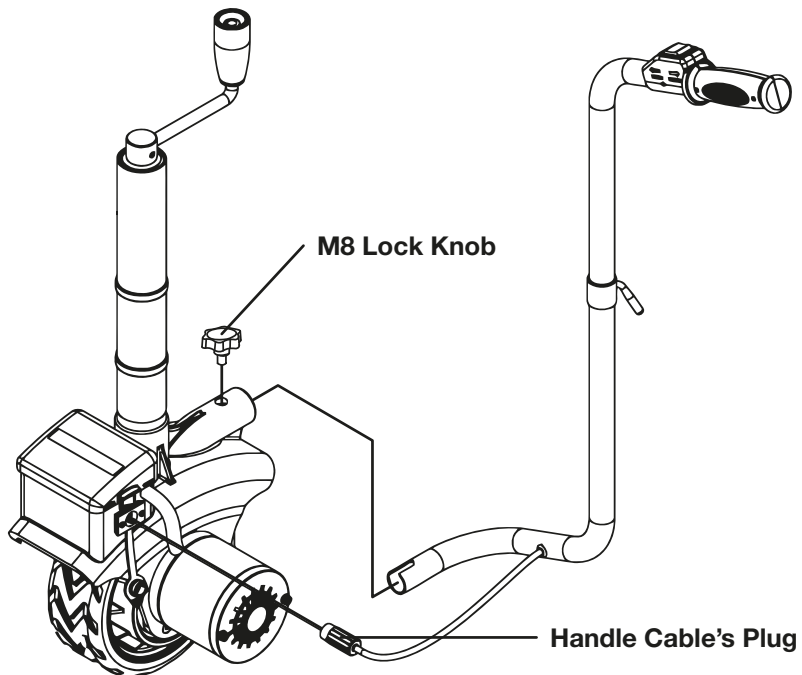

**Step 3:** Insert the **Latch Pressure Plate** into the **Latch Fixed Plate**, then attach the **Latch Fixed Plate** to the drawbar of vehicle by the using **2 x M12-120 Hex Bolts**, **2 x M12 Flat Washers** and **2 x M12 Nylon Lock Nuts**.

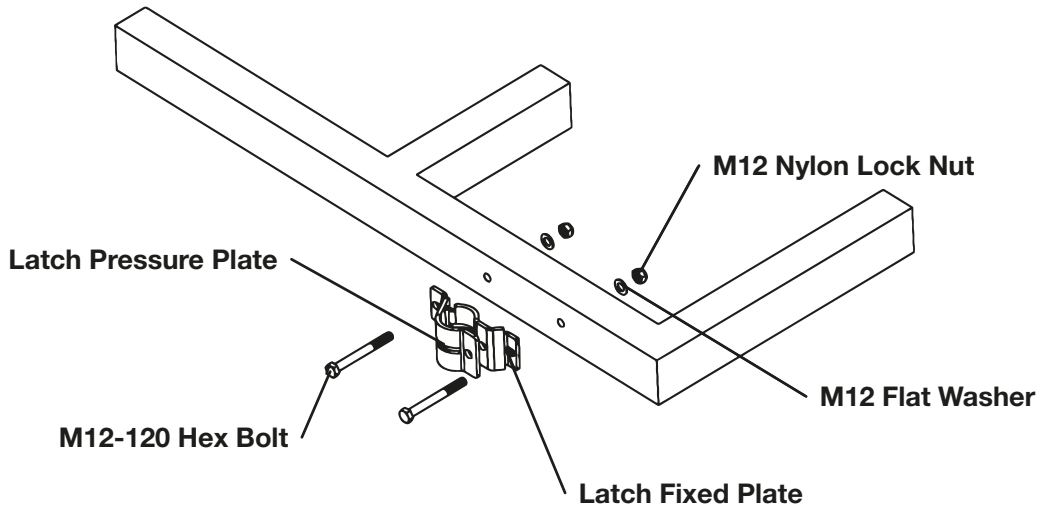

**Step 4:** Lock the **Latch Pressure Plate** together with the **Latch Fixed Plate** by using the **M12 Flat Washer** and **M12-40 Hex Bolt**.

Ensure that the **Rib** is locked into the **slot** on both the **Latch Fixed Plate** and the **Latch Pressure Plate** before tightening.

Use the **Correct Rib** for the lowest operating height is selected when in use.

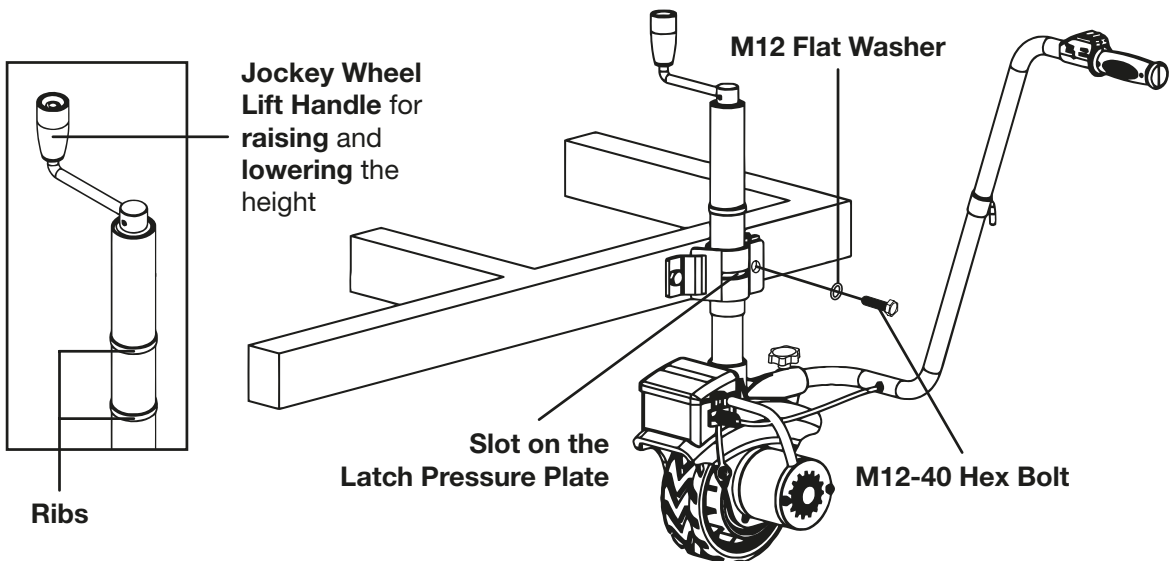

**Step 5:** Connect the **Power Cable** into the **Power Socket** on the **Control Box**. Connect the **RED** end to the **Positive Terminal** and connect the **BLACK** end to the **Negative Terminal**. Connect the **50 Amp Connector** to the **12V DC Power Source**.

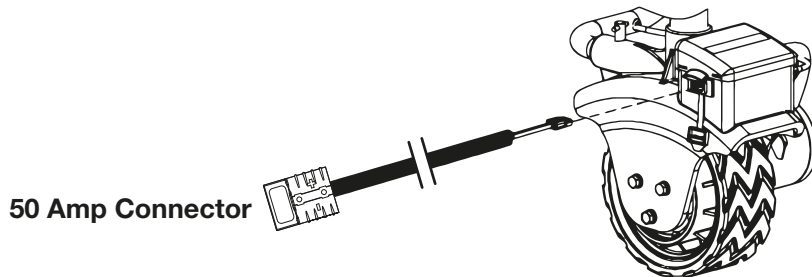

**Step 6:** After all the installation are completed, press the **ON/OFF Power Switch** to power **ON** or **OFF** the **Electric Motorised Jockey Wheel**. Make sure to tie up the **Power Cable** neatly.

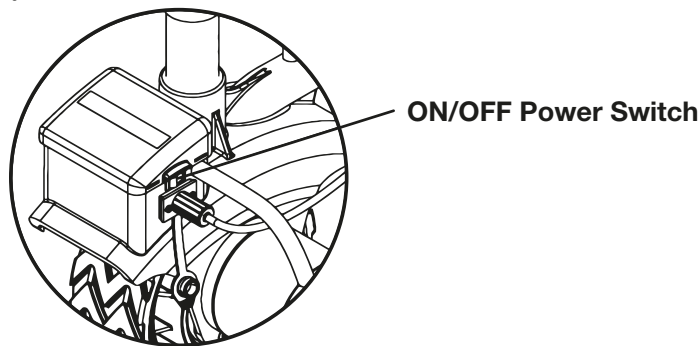

### TIPS FOR SAFE OPERATION

1. **Electric Motorised Jockey Wheel** is rated at **2,270kg Maximum Vehicle Load** and **272kg Maximum Jockey Wheel Load**. Overloads can damage the **Electric Motorised Jockey Wheel's** motor and **Solid Rubber Wheel** etc.
2. Make sure all nuts and bolts etc are securely fastened before operating the **Electric Motorised Jockey Wheel**.
3. Check if **Power Cable** is connected correctly and all connections are tight.
4. **DO NOT** use **Power Cable** that is in poor condition, squashed, torn or any other visible damage.
5. This **Electric Motorised Jockey Wheel** is equipped with a **30A Auto Reset Circuit Breaker** from overheating of the motor. Once the **Circuit Breaker** is activated, stop working for 5 minutes, let motor cool down before resume to use the **Electric Motorised Jockey Wheel**.
6. Avoid the use of the **Electric Motorised Jockey Wheel** in wet conditions (rain).

**OPERATION GUIDE**

- \* Take time to assess your situation and plan your movement.
- \* Mount the **Electric Motorised Jockey Wheel** to the drawbar of the vehicle. Locking pin and cover (not included) are recommended.
- \* Assemble the **Handlebar**, connect the **Power Cable** into the **Power Socket** on the **Control Box** and connect the **50 Amp Connector** of the **Power Cable** to the **12V DC Power Source**.
- \* Press the **Button** on the **Control Handle** to move the **Electric Motorised Jockey Wheel** in the desired direction you wish to move the **Electric Motorised Jockey Wheel**.



**MAINTENANCE**

All moving parts within the **Electric Motorised Jockey Wheel** have been lubricated using high temperature lithium grease. No internal lubrication is required.

If the **Electric Motorised Jockey Wheel** is being used in high moisture conditions for long periods of time, internal lubrication will be necessary, please find a professional technician for maintenance.

**TROUBLESHOOTING**

<b>PROBLEM</b>	<b>CAUSE</b>	<b>SOLUTION</b>
Motor does not turn on	<ul style="list-style-type: none"> <li>• Circuit breaking</li> <li>• Power Cable’s connection loose</li> <li>• Motor failure</li> <li>• Circuit breaker activated from overheating of the motor</li> </ul>	<ul style="list-style-type: none"> <li>• Press the ON/OFF power switch on the control box</li> <li>• Check all connections are tight</li> <li>• Replace motor</li> <li>• Stop working for 5 minutes, let motor cool down</li> </ul>
Slow motor speed	<ul style="list-style-type: none"> <li>• Low voltage on motor or too much weight on jockey wheel</li> </ul>	<ul style="list-style-type: none"> <li>• Recharge battery</li> <li>• Check weight on jockey wheel</li> </ul>
Loud noise emitted from motor	<ul style="list-style-type: none"> <li>• Jockey wheel is overloaded</li> <li>• Jockey wheel is being used on a greater than 5°</li> </ul>	<ul style="list-style-type: none"> <li>• Decrease weight on jockey wheel</li> <li>• Cease using jockey wheel if incline is greater than 5°</li> </ul>

**SPECIFICATIONS:**

INPUT VOLTAGE:	12V DC
PEAK WORKING CURRENT:	30 Amp
NORMAL WORKING CURRENT:	15-27 Amp
RECOMMENDED BATTERY SIZE:	24Ah
MAXIMUM VEHICLE LOAD:	2,000kg (4,400lb)
MAXIMUM JOCKEY WHEEL LOAD:	272kg
MINIMUM HEIGHT:	680mm
MAXIMUM HEIGHT:	970mm
EXTENSION:	290mm
GEAR RATIO:	326:1
OPERATION:	Forward & Reverse
BRAKING ACTION:	Automatic
MAXIMUM SPEED:	6-7 Metres Per Minute
MAXIMUM INCLINE:	5 Degrees
CABLE LENGTH:	1.6 Metres
SOLID RUBBER WHEEL:	Ø192 x W69mm
ELECTRICAL PROTECTION:	30A Auto Reset Circuit Breaker
OVERALL DIMENSIONS:	L68 x W40 x H80cm
NET WEIGHT:	13.50kg



PLU: 632324 CODE: JW01  
Manufactured and Packaged for SRGS PTY LTD ABN 23 113 230 050  
6 Coulthards Avenue, Strathpine, Queensland 4500, Australia  
**MADE IN CHINA**



Recyclable Paper